

# HIGHLANDTOWN VILLAGE

BALTIMORE, MD | 3800 EAST LOMBARD STREET

BROAD STREET



**Join Leading International Grocer, Hazlo, Dollar Tree & Domino's**

5,850 SF Available



**2022 DEMOGRAPHICS**

**2022**  
POPULATION

1 MILE	3 MILES	5 MILES
34,432	193,911	494,726

**AVERAGE**  
HOUSEHOLD INCOME

1 MILE	3 MILES	5 MILES
\$106,238	\$84,949	\$76,823

**MEDIAN**  
AGE

1 MILE	3 MILES	5 MILES
36	37	36.9

**DAYTIME**  
EMPLOYEES

1 MILE	3 MILES	5 MILES
14,714	166,200	288,958

**TRAFFIC**  
COUNT

E Baltimore Street  
VPD: 23,560



**DEMOGRAPHICS**



**2022 POPULATION BY RACE**

**CAUCASIAN**

1 MILE	3 MILES	5 MILES
21K	85K	200K

**AFRICAN  
AMERICAN**

10K	97K	251K
-----	-----	------

**AM. INDIAN  
& ALASKAN**

623	1.6K	3K
-----	------	----

**ASIAN**

820	6K	15K
-----	----	-----

**HAWAIIAN  
& PACIFIC ISLAND**

180	337	504
-----	-----	-----

**OTHER**

1K	4.8K	13K
----	------	-----

**HISPANIC  
ORIGIN**

8K	20K	33K
----	-----	-----

Note: Numbers are rounded up





Prominent visibility on busy thoroughfare and located in Baltimore's growing Highlandtown neighborhood. 35,024 residents within 1-mile.

Densely populated and residential area with multiple developments planned. 10,249 multifamily units within 2-miles. 39,807 households within 1-mile.

Retail mix of national retailers and necessity-based retail operators. International grocer with strong sales record.

5,000 daytime employees within 1 mile; John Hopkins, Amazon (fulfillment centers), and H&S Bakery all within close proximity.



**DOLLAR TREE**







**PATTERSON PARK**

**JOHN HOPKINS BAYVIEW MEDICAL CENTER**

E BALTIMORE ST

E LOMBARD ST







UNIT	SF	TENANT
3800	26,904	Hazlo International Supermarket
3810	1,000	MetroPCS
3812	1,500	T&M Carry Out
3816	750	China Chef
3820	11,200	Dollar Tree
3830	2,000	Song's Beauty Supplies
3834	1,000	Tobacco Barrel
<b>3842</b>	<b>5,850</b>	<b>AVAILABLE</b>
3848	900	EZ Nails
3858	979	Value Wireless
3860	1,430	Subway
3870	1,500	Domino's
3872	2,500	Super Discount Liquors

**HIGHLANDTOWN VILLAGE SHOPPING CENTER**  
BALTIMORE, MD | 3800 EAST LOMBARD STREET

# MARKET AERIAL



**UNIT 3842**

5,850 SF Available

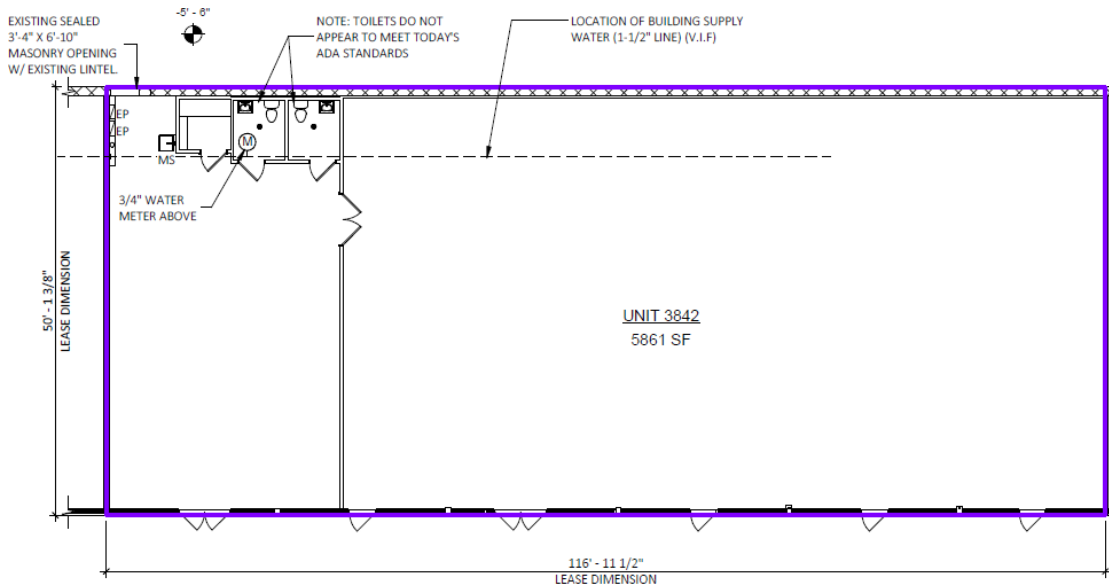

LEASABLE AREA	5,861 SF
SPRINKLERED	NO
FIRE ALARM	NO
NO. OF EXITS	6
EXISTING USE	M
FL TO U/S STRUCT HT	+/- 13'- 10" FT
RESTROOMS	2
CEILINGS	
RESTROOM & STORAGE	7 11 3/4" AFF, GWB
STOREFRONT	
ALUMINUM	8'- 7 1/2" H

## LEGEND

(W)	WATER METER	DF	DRINKING FOUNTAIN
EP	ELECTRIC PANEL	MS	MOP SINK
[F]	FIRE ALARM	(WH)	WATER HEATER
(T)	THERMOSTAT	FD	FLOOR DRAIN
(M)	ELECTRIC METER	CO	CLEAN OUT



# HIGHLANDTOWN VILLAGE

BALTIMORE, MD | 3800 EAST LOMBARD STREET



## About Broad Street Realty

Broad Street Realty, Inc., is a vertically integrated and self-managed publicly owned real estate company that has grown their owned portfolio to 18 shopping centers and 2.1 Million square feet of retail in the Mid-Atlantic Region and the Denver Urban Corridor. The company has extensive experience in real estate development, property management, asset management, and both landlord and tenant representation. Broad Street Realty maintains offices in Washington DC, Maryland, Virginia and Colorado.



### MARISA MICHNICK

Vice President of Retail Leasing  
D: 301.828.1213 | C: 301.503.2214  
mmichnick@broadstreetrealty.com



### DANE TEKIN

Vice President of Retail Leasing  
D: 301.828.1230 | C: 202.744.3940  
dtekin@broadstreetrealty.com

Broad Street Realty, Inc.  
7250 Woodmont Ave | Bethesda, MD 20814  
www.broadstreetrealty.com  
Washington DC | Maryland | Virginia | Colorado